

# FUNDATIE TIP FT18 / FOUNDATION TYPE FT18

Vedere de sus A-A / Top view A-A  
Scara 1:20 / Scale 1:20

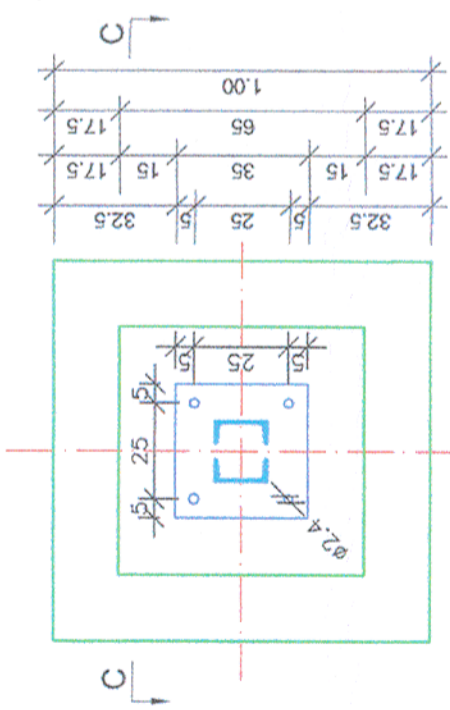

Vedere de sus B-B / Top view B-B  
Scara 1:20 / Scale 1:20

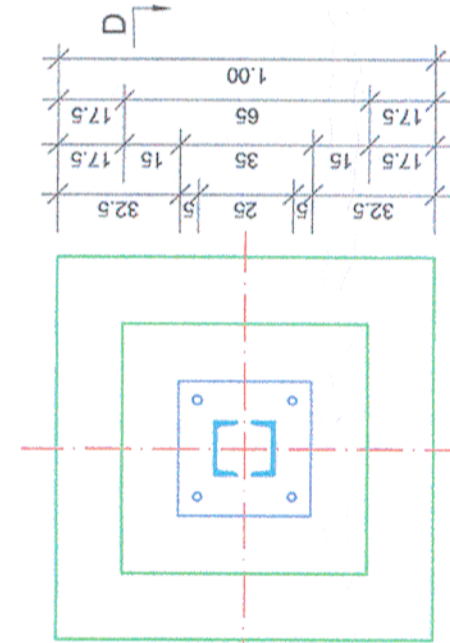

Sectiune transversala C-C / Cross section C-C  
Scara 1:20 / Scale 1:20

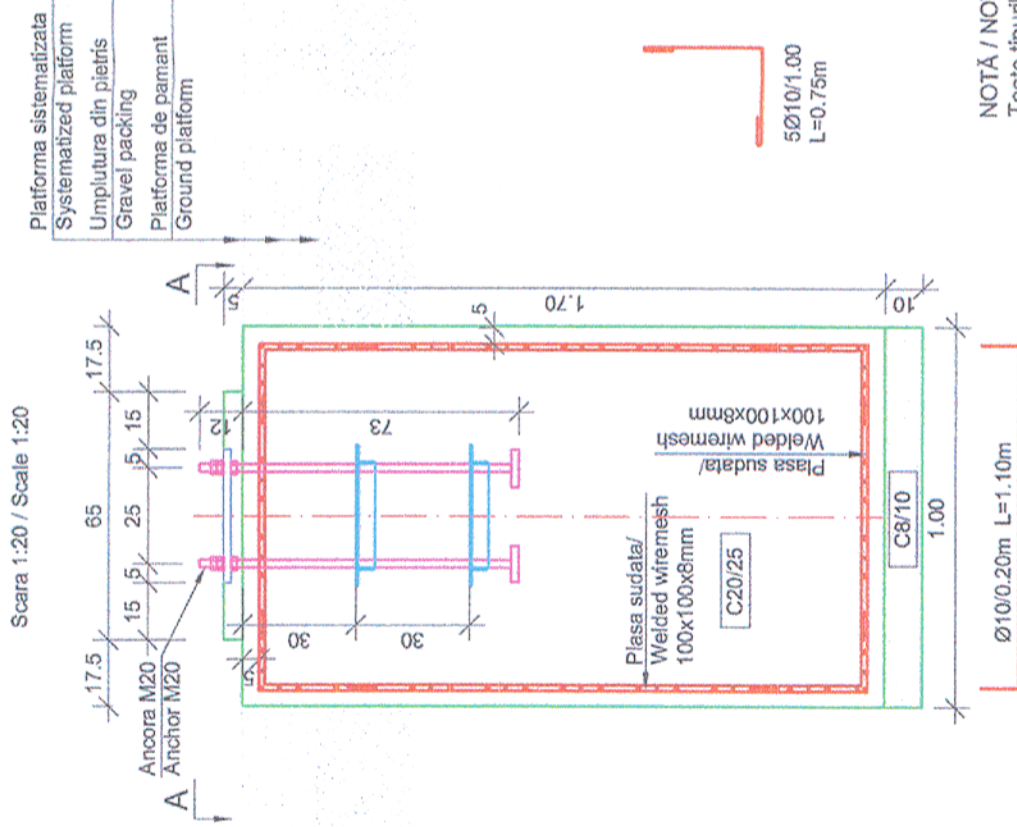

Sectiune transversala D-D / Cross section D-D  
Scara 1:20 / Scale 1:20

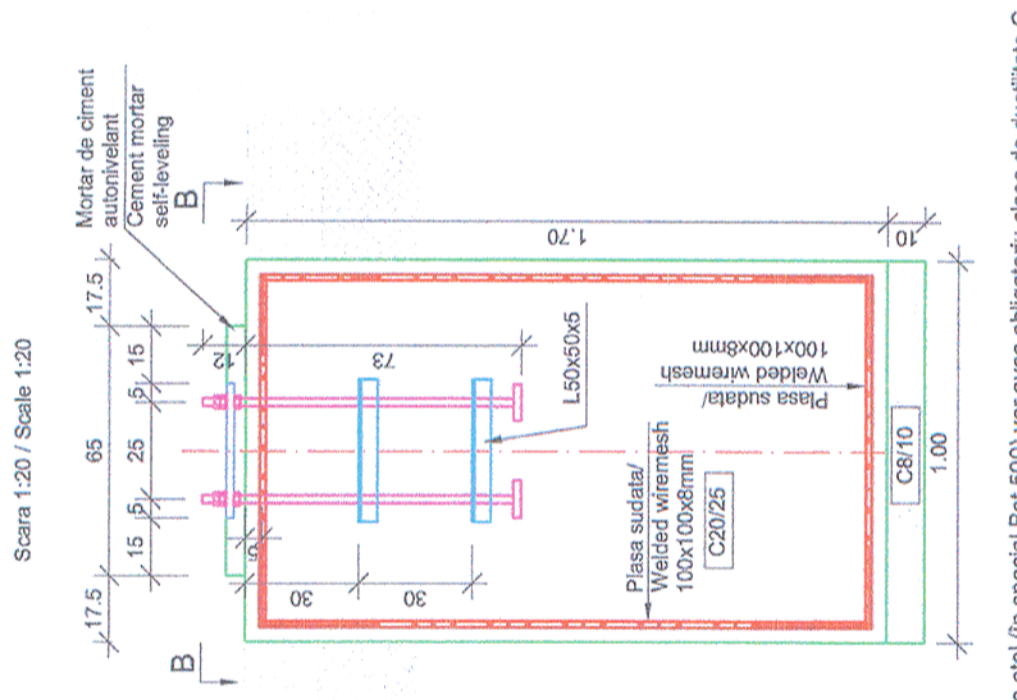

NOTĂ / NOTE:  
Toate tipurile de oțel (în special Bst 500) vor avea obligatoriu clasa de ductilitate C.  
All types of steel (especially Bst 500) will mandatory have the ductility class C.

THE CONSTRUCTION IMPORTANCE CLASS,  
ACCORDING TO P 100/1-2006, IS (III)  
THE IMPORTANCE CATEGORY,  
ACCORDING TO HG 766/97 IS "C"

MATERIALS:

Beton simplu C8/10 ;  
Beton armat C20/25 CEM III/A-S 42.5 N ; sort 0-31; A/C : 0.55 ;  
Oțel Beton Bst 500 ;  
Clasa de expunere: XC2

CLASA DE IMPORTANTA A CONSTRUCȚIEI  
CONFORM P 100/1-2006 ESTE (III)  
CATEGORIA DE IMPORTANTA  
CONFORM HG nr. 766/97 este (C)

MATERIALE:

Beton simplu C8/10 ;  
Beton armat C20/25 CEM III/A-S 42.5 N ; sort 0-31; A/C : 0.55 ;  
Oțel Beton Bst 500 ;  
Clasa de expunere: XC2

Acest plan anuleaza si inlocuieste planul nr. PT.02.04.06.RE.09.012 elaborat la data 01.2013.

This layout plan canceled and replaced layout plan no. PT.02.04.06.RE.09.012 prepared on 01.2013.

Proiectul de structura se va corela cu proiectul celorlalte specialitati (parte scrisa si parte desenate).  
The structural project (blueprints, technical briefs, technical specifications) will be correlated with the other specialitis' projects (blueprints, technical briefs, technical specifications).

|                                                                                                                                                                             |                       |                                            |                                           |                                                   |                        |
|-----------------------------------------------------------------------------------------------------------------------------------------------------------------------------|-----------------------|--------------------------------------------|-------------------------------------------|---------------------------------------------------|------------------------|
|                                                                                                                                                                             |                       |                                            |                                           |                                                   |                        |
|                                                                                                                                                                             |                       |                                            |                                           |                                                   |                        |
| Verificator / Expert<br>Checker / Expert                                                                                                                                    | Cerința / Requirement | Semnătura / Signature                      | Referat / Expertiză<br>Report / Expertise | Data<br>Date                                      | Semnătura<br>Signature |
|                                                                                                                                                                             |                       |                                            |                                           | 01.2013                                           |                        |
|                                                                                                                                                                             |                       |                                            |                                           | 01.2013                                           |                        |
| Aprobat / Approved                                                                                                                                                          |                       | Șef de echipă / Team leader                |                                           | C. Teodorescu                                     |                        |
| Verificat / Checked                                                                                                                                                         |                       | Expert Cheie / Key Expert                  |                                           | R. Witan                                          |                        |
| Subcontractant / Subcontractor                                                                                                                                              |                       |                                            |                                           |                                                   |                        |
| Aprobat / Approved                                                                                                                                                          |                       | Adjunct Șef de echipă / Deputy Team leader |                                           | A.M. Baicu                                        |                        |
| Proiectat / Designed                                                                                                                                                        |                       | Inginer / Engineer                         |                                           | G. Staicu                                         |                        |
| "Reabilitarea liniei c.f. Frontieră - Curtici - Simeria, parte componentă a coridorului IV Pan - European pentru circulația trenurilor cu viteză maximă de 160 km/h"        |                       | Tronsonul 2 - A: km 614 - Cap Y Bârzava    |                                           | Project 9i<br>35311.1                             |                        |
| "Rehabilitation of the Railway Line Border - Curtici - Simeria, component Part of the IV Pan - European Corridor for the Trains Circulation with maximum speed of 160 km/h" |                       | Section 2 - A: km 614 - End Y Bârzava      |                                           | Faza / Phase:<br>PTh+CS / TD+TS                   |                        |
| Denumire desen / Drawing name:<br>Fundatie tip FT18 - Substație de tracțiune - Stația Radna /<br>Foundation type FT18 - Traction substations - Radna Station                |                       |                                            |                                           |                                                   |                        |
| Scara / Scale<br>1:20                                                                                                                                                       |                       | Revizia / Revision<br>1/05.2013            |                                           | Cod desen / Drawing Code<br>PT.2A.03.06.RE.09.012 |                        |
|                                                                                                                                                                             |                       |                                            |                                           | Nr / No<br>12/12                                  |                        |